

ATTENZIONE! NON USARE L'APPARECCHIO SENZA AVER LETTO LE ISTRUZIONI PER L'USO.
¡ATENCIÓN! NO UTILICE EL APARATO SIN HABER LEÍDO ANTES LAS INSTRUCCIONES DE USO.
ATTENTION! N'UTILISEZ PAS L'APPAREIL SANS AVOIR LU LES INSTRUCTIONS D'UTILISATION.
VORSICHT! VOR EINER INBETRIEBNAHME DES GERÄTS UNBEDINGT DIE GEBRAUCHSANWEISUNG LESEN.
ATTENTION! DO NOT USE THE APPLIANCE WITHOUT READING THE INSTRUCTIONS FOR USE.
OPGELET! LEES VOORDAT U DE MONDIALVAP GEBRUIKT, DEZE INSTRUCTIES AANDACHTIG DOOR.
ATENÇÃO! NÃO UTILIZAR O APARELHO SEM ANTES TER LIDO AS INSTRUÇÕES

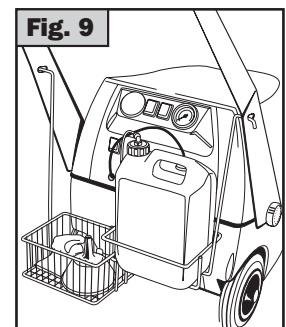

Fig. 1A

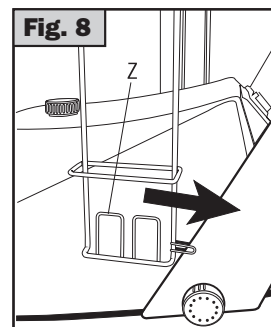
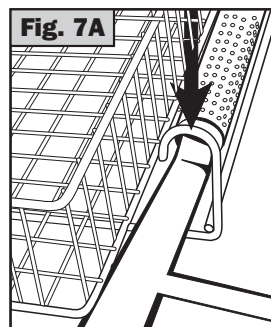
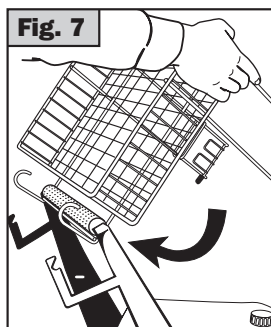
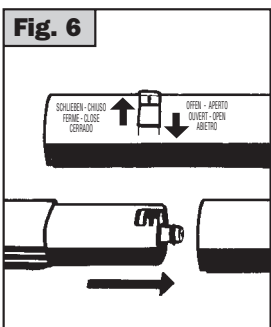
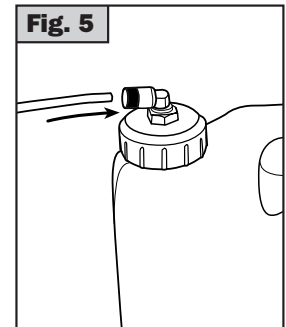
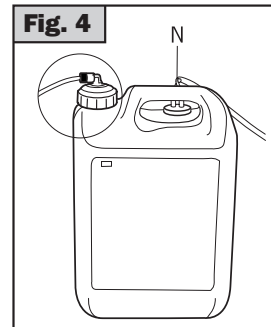
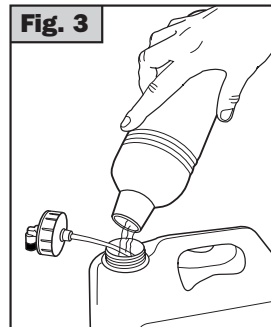
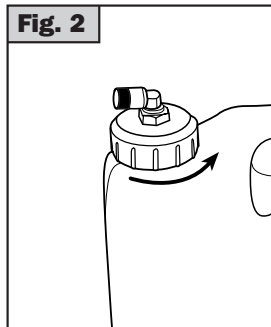
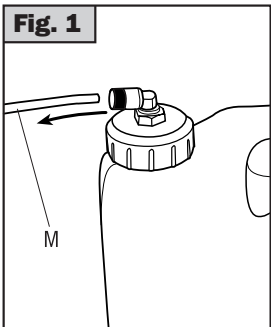
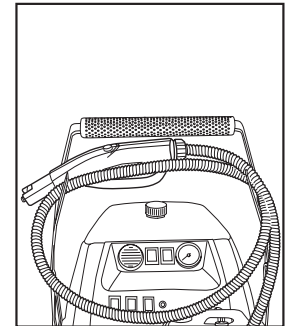
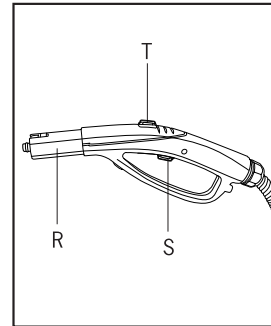
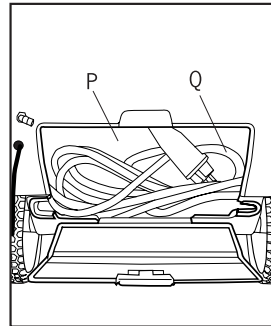
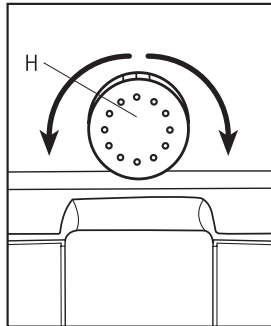
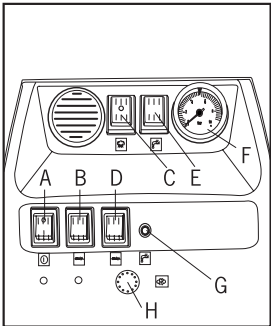
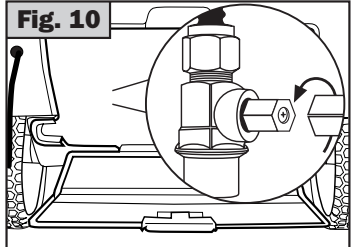
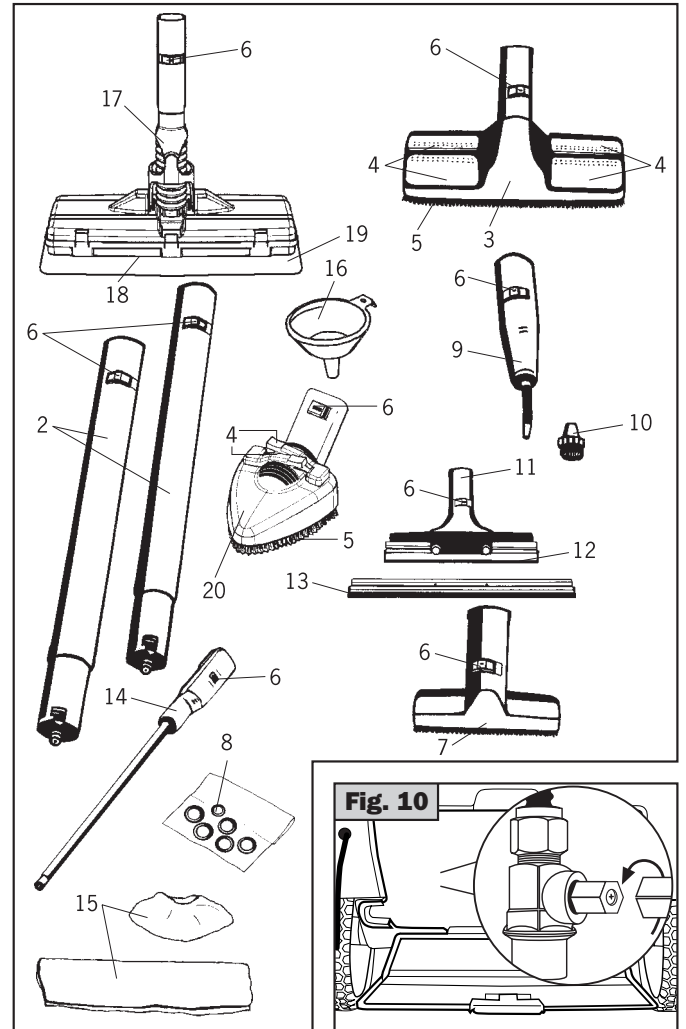
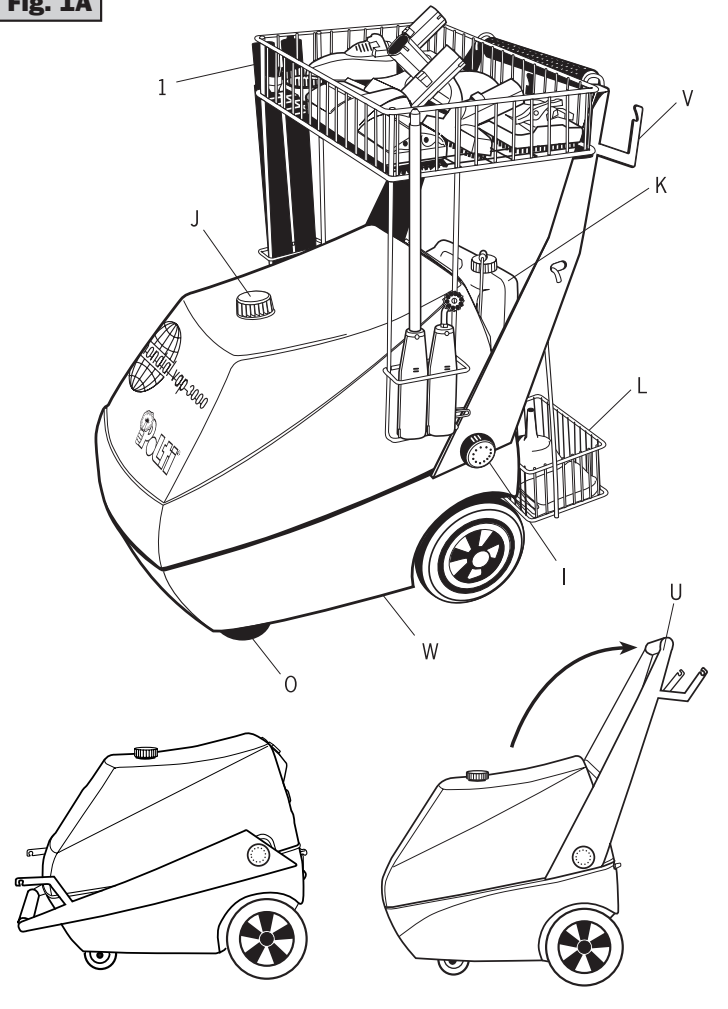

WARNING

Attention! Do not use the appliance without reading the instructions for use.

In case of breakdown or malfunction do not attempt to repair the appliance yourself but refer to your nearest authorised Service Centre.

In case of a reduction in steam emission strength, have the clean state of the generator's level sensor checked at the nearest Polti authorised Service Centre.

The electrical system the appliance is connected to must be realised in accordance with the current rules. We recommend the presence of a differential magnetothermic switch, with sensibility equal to 30 mA, at the source of the power socket or of the electrical system.

Attention! this appliance has been designed for use exclusively with the detergent recommended by the manufacturer. The use of other products can compromise the safety of the appliance.

Attention! do not use the appliance when other people are in the working area, unless they wear protective clothes.

Attention! the steam jet under pressure can be dangerous if incorrectly used. Never direct the steam jet at people, electrical parts of other appliances or towards the appliance itself.

Never direct the steam jet towards yourselves or other people to clean clothes or shoes.

The appliance must not be used by children or by people who are not familiar with the usage instructions.

In order not to compromise the safety of the appliance, use only original spare parts and accessories, approved by the manufacturer.

Do not use the appliance if the supply cable or other important parts of the appliance are damaged. The supply cable must be replaced by the manufacturer or by its Service Centre or anyway by a similarly qualified person, so as to prevent any risk.

If an extension cable is used, the plug and the socket must be watertight. Attention! the use of an unsuitable extension cable can be dangerous.

Attention! this appliance must be watched during operation.

PRECAUTIONS

- Check that the machine has water and detergent
- Check that the detergent reservoir is connected (tube securely fastened and electrical connector well in its place).

GUARANTEE

The Mondialvap 3000 is guaranteed to the original purchaser for one year from purchase date against manufacturing or raw material defects. The guarantee is not valid if the appliance has been misused in any way. Unauthorised alterations or repairs to the machine will automatically invalidate this guarantee.

Politi declines liability for any damage or accident derived from any use of Mondialvap 3000 which is not in conformity with the instructions contained in this booklet.

ATTENTION

The appliance is built according to the current recycling rules.

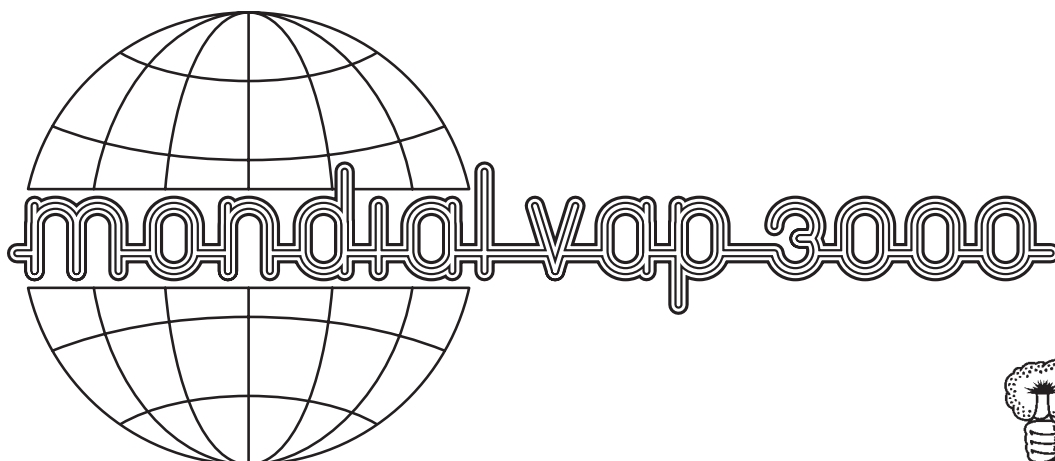

MACHINE BODY LEGEND

- | | |
|--|--|
| A) Mains supply switch | L) Reservoir support |
| B) Starter switch | M) Detergent supply tube |
| C) Switch for activating electrovalve and detergent pump | N) Detergent level sensor |
| D) Indicator light (green) -steam generator in operation | O) Pivoting wheels |
| E) Indicator light (yellow) - lack of water in the boiler | P) Handgun and supply cable storage compartment |
| F) Visual pressure gauge | Q) Hose |
| G) Indicator light - low water level in the reservoir | R) Hand gun with control switches |
| H) Steam volume control knob | S) Steam control switch (low voltage) |
| I) Side lock-down nut for handle | T) Detergent control switch (low voltage) |
| J) Water reservoir cap | U) Handle |
| K) Detergent reservoir | V) Hand gun storage projections |
| | W) Boiler cock |
| | Z) Extension tube storage |

ACCESSORIES LEGEND

- | | |
|--|---------------------------------------|
| 1 Accessories basket | 11 Window squeegee tool |
| 2 Extension tubes | 12 Small blade for window tool |
| 3 Large brush | 13 Large blade for window tool |
| 4 Cloth retaining clips | 14 High pressure lance |
| 5 Replaceable bristles plate | 15 Cotton cloths |
| 6 Accessories locking button | 16 Funnel |
| 7 Small brush | 17 MOP Brush |
| 8 Spare washers for accessory connections | 18 Microfibre cloth frame |
| 9 120° nozzle | 19 Microfibre cloth (opcional) |
| 10 Small round brush for 120° nozzle | 20 Triangular Brush |

TECHNICAL DATA AND CHARACTERISTICS

• Power supply	220V/240V ~ 50Hz
• Total power consumption	3100 W
• Resistance (heating element)	3000 W
• Control switch voltage	12 V
• Protection degree from water	IP 24
• Level of estimated sound pressure	< 70 dB
• Vibration level	< 1 m/s ²
• Generator tank volume	5 litres
• Maximum water capacity in generator	3 litres
• Maximum operating pressure	5 bar
• Pressostat operation setting	5 bar
• Operating temperature at 5 bar pressure	150°C
• Safety valve, cod.M0002228, operates at	7 bar
• Maximum capacity of reservoir	6 litres
• Steam volume (variable)	0-70 gm/min.
• Hose length	8 metres
• Low voltage steam and detergent switches on handgun	
• Minimum and maximum water level sensor in generator	
• Minimum level sensor in water reservoir	
• Minimum level sensor in detergent reservoir	
• Water refill pump	
• Detergent pump	
• Visual and audible "water empty" indicator from water reservoir	
• Audible "detergent empty" indicator	
• Automatic cut-out of water and detergent when "water empty" at reservoir	
• Visual lack of pressure or lack of water indicators in generator	

PRINCIPLES

The basic principle of MONDIALVAP 3000 with auto refilling is conceived for cleaning various types of surfaces with the simple use of steam and, if desired, by mixing water and detergent, which a high exit pressure is given to.

The cleaning action takes place thanks to the coexistence of 3 important factors: volume, temperature, humidity.

The volume determines the impact of the fluid with the surface to be treated, takes off and removes the dirt in the same way as an imaginary blade, but without scratching the treated areas. The temperature is an important steam component, in fact it has a double role: it melts the dirt to make pickup easier and disinfects the surfaces. The steam humidity, when in contact with dirt, makes it soft by changing the principal physical characteristics of consistency, hardness and adhesion. To further increase the power of Mondialvap 3000 it is possible to mix the detergent with the steam temperature obtaining thus a strong chemical action with a small dose.

SAFETY SYSTEM

The materials the appliance is made of are of an excellent quality and suitable to support mechanical and thermic stress without changing their physical characteristics.

Different intervention levels of the devices foreseen by the current rules contribute to cancel the possibility that further damages may compromise the safety of the appliance.

DETERGENT SYSTEM

This appliance incorporates an auxiliary reservoir for detergent, which introduces detergent into the steam flow by a special pump and valve.

The reservoir must be filled with liquid products without foam.

An internal sensor monitors the detergent level and sounds a warning signal if the machine runs short of detergent.

To fill the detergent reservoir proceed this way:

1. Disconnect the tube from the cap (Fig.1)
2. Unscrew the cap, then refill (Fig. 2-3)
3. Screw on the cap again (Fig. 4)
4. Reconnect the tube to the cap (Care! connect tightly) (Fig. 4-5)

CARRYING HANDLE (U)

Positioning the handle for use:

- unscrew the two lock-down nuts (**I**) at the sides of the handle
- lift the handle (**U**) until it is hooked in its place (Fig. 1A)
- screw on the two lock-down nuts (**I**) tightly.

To lower the handle, proceed in the reverse order.

Two projections (**V**) on top of the handle allow to store the hose (**Q**) at the end of operations or they can be used even during the working phase if the hose length becomes obtrusive.

ACCESSORIES BASKET (1)

Positioning the basket for use:

- Make sure the handle (**U**) is correctly positioned.
 - Hook the accessories basket (**1**) to the handle (**U**) (fig. 7) by turning it towards the appliance.
 - fix the two extension tube storage (**Z**) in the lower part of the handle (fig. 8).
 - Make sure the basket is correctly assembled (fig. in the legend)
 - Place the accessories on the basket as described in the figure in the legend.
-

OPERATING INSTRUCTIONS

- Position the reservoir support (**L**) on the handle (**U**) as shown in fig.9.
- Position the detergent reservoir (5 litres) (**K**) on the support (**L**) and connect the detergent tube (**M**), screwing up tightly. We recommend the use only of liquid detergent (non-foaming).
- Check that the tanks are full of water and detergent.
- Check that the detergent tank is connected (tube is properly inserted in the connection) fig. 4.
- Connect MONDIALVAP 3000 to the mains (220/240V 50Hz).
- Switch on the mains supply switch (O-I) and check that the indicator light comes on.
- Switch on the starter switch (**B**) and check that the green indicator light (**D**) comes on (the elements start to heat the water).
- Heating will commence and continue until the pressure gauge reaches 5 bar (about 10 mins.).
- At 5 bar the pressostat will switch off the heating elements and the green light (**D**) goes out, indicating that the machine is now ready for use.
- Switch on the steam on-off and detergent switch (**C**).
- Start the steam flow using the switch on the handle (**S**).
- By switching on the other switch (**T**) on the handle you can release detergent together with the steam.

FILLING THE GENERATOR

When the water in the generator reaches minimum level, the level sensor automatically draws water from the reservoir by operating a pump, refilling the generator.

ELECTRICAL SYSTEM

Apart from the two security systems (pressostat and safety valve) there is also a thermostat (which is manually re-armable) which will intervene to protect the machine in case of any electrical malfunction. The rearming of the thermostat can only be done by a Polti Authorised Service Centre.

The switches for the electrovalve for steam output and for the detergent pump are both low voltage (12V).

STEAM REGULATION FEATURE

MONDIALVAP 3000 is equipped with a steam regulator control (**H**). You can use this control to increase the steam flow by turning it in an anti-clockwise direction. Turning the control in a clockwise direction reduces the steam flow.

PRESSURE LEVEL GAUGE

MONDIALVAP 3000 is equipped with a visual pressure level gauge (**F**).

CONNECTION OF ACCESSORIES

To connect the accessories tools to the hand gun (**R**) proceed as follows (fig. 6):

- Move the connector button (**6**) on the accessory to the "open" position.
- Attach the required tool to the hand gun (**R**).
- Move the connector button (**6**) back to the position "closed".
- Check that the connector button has engaged and the accessory is fully connected.

TIPS FOR BETTER UNIT PERFORMANCE

- For cleaning leather, wood or delicate fabrics especially dralon, velvet and other pile surfaces, consult the manufacturers instructions. Clean only by using the hand gun at a safe distance together with a soft cloth and always do a test on a non visible part of the item first or on a sample. Allow the test area to dry completely before observing results and effects on surface or colour before proceeding to clean further areas, ensuring that exactly the same distance and technique are applied as for the test area.
- For cleaning wood surfaces (furniture, doors, etc.) take great care as too long an application of the steam could alter the waxed appearance, the shine or the colour of the surfaces cleaned. We therefore recommend you apply the steam on such surfaces only for brief periods or to clean these surfaces using a cloth first held in the steam.
- On delicate surfaces (e.g. synthetic materials, lacquered surfaces etc.) we recommend that the small brush should always be covered with a cloth (15).
- If cleaning glass surfaces in particularly low temperatures preheat the glass using the hand gun **(R)** from about 50 centimetres distance from the surface to be cleaned.
- For the care of your plants vaporise at a minimum distance of 50 centimetres.

STEAM GUN (R)

The steam gun can be used directly on all spots requiring a stronger, closer treatment without connecting the brushes. The more resistant the stain, the closer you should hold the gun; the steam pressure and temperature being higher at the source. You should however always wipe with a dry cloth or a slightly abrasive sponge if the stain is a difficult one to remove after using the gun.

The steam gun (R) is particularly efficient at:

- breaking down rug and carpet stains before they are treated with the large brush.
- cleaning stainless steel surfaces, panes, mirrors, enamelled surfaces.
- cleaning hard-to-reach corners, such as stairs, window sills, door posts, aluminium outlines.
- cleaning tap bases.
- cleaning windows shutters, heaters, car interiors.
- spraying plants from a distance.
- removing odours and creases from clothes.

To reach higher points, the steam gun **(R)** can be connected to one or both extension tubes **(2)**.

LARGE BRUSH (3)

Use the large brush **(3)** with one or two extension tubes **(2)** on all large washable surfaces. To wash floors, put a clean, dry kitchen cloth under the brush and swing back and forth without applying any pressure. Use the other side of the cloth when the first one is impregnated with dirt. Use the brush **(3)** directly without the cloth on particularly dirty or encrusted areas and in spaces between the tiles: swing the brush sideways to detach the dirt.

Highly obstinate stains may require a steam gun treatment before the brush and cloth are used (an old bath towel is an ideal cloth). The same procedures apply to ceilings and vertical surfaces, like wallpaper: in this case the cloth can easily be fastened around the brush **(3)** and held in place by the four clips on the brush itself. Smooth cotton cloths are suitable for the treatment of glass surfaces: fasten the cloth around the brush then pass it over the window pane (or mirror) to remove the greasy film. Finally, spray the surface with the steam gun and wipe dry with a clean cloth. In cold weather, window panes will require pre-heating with the steam gun (from a distance of 50 cm), prior to the actual cleaning with the brush.

Mondialvap 3000 is ideal for both synthetic and wool rugs as well as for all types of carpets. Its use will ensure total hygiene, revive colours and restore the original brilliance of the pile. The treatment can be repeated as frequently as you wish, with no damage whatsoever. Drying occurs practically at once. Use the brush **(3)** without cloth on the surface to raise the dirt. Then, fold a cotton cloth over 2 or 3 times (according to the resistance of the pile) and fasten it with the clips **(4)** onto the brush. Move the brush **(3)** rapidly in all directions without applying any pressure. You should avoid lingering in the same place, as this may soak the area. Particularly dirty rugs may need several treatments. Obstinate spots may require the use of the steam gun **(R)** prior to treatment.

SMALL BRUSH (7)

The small brush **(7)** is designed to perform the same operation as the large brush, only on smaller surfaces. It can be connected to the steam gun **(R)** with one or two extension tubes **(2)**. The small brush is suitable for:

- upholstery fabrics (resistance and colour fastness should be tested previously on a hidden piece of fabric, allowed to dry and results evaluated).
- velvets and leather (from a distance).
- car interiors, windshields.
- small glass surfaces, tiled surfaces.

When cleaning wood surfaces (doors, floors, etc) do not use naked steam, but cover the brush (large **3** or small **7**) with a cotton cloth folded into a number of thicknesses.

For cleaning furniture spray the steam onto a dry cotton cloth then wipe with the cloth.

The warm moist cloth will pick up dirt and static, so that the furniture remains cleaner longer thanks to the absence of sticky film from chemical cleaning products.

120° STEAM NOZZLE (9)

The 120° nozzle (which can be connected directly to the gun **(R)** or together with the extension tubes) allows you to concentrate a powerful jet of steam to otherwise inaccessible locations, such as radiators, door posts, sills and shutters, as well as for sterilising toilet bowls.

WINDOW SQUEEGEE TOOL (11 - 12 - 13)

The window squeegee tool **(11)** allows you to clean effectively and rapidly all glass surfaces without using detergents.

Your glass will remain cleaner longer thanks to the absence of layers of film normally left behind by chemical cleaning products on which new dust and grease can attach itself.

Cleaning glass is done in two stages:

- spraying the steam onto the surface to be cleaned to loosen the dirt.
- Pulling the blade straight down the window surface from top to bottom without applying the steam, to take away the dirt.

To clean especially large glass surfaces, attach the window squeegee tool **(11)** to the extension tubes **(2)**.

LONG STEAM LANCE (14)

This accessory allows you to reach the most inaccessible places. Ideal for cleaning large radiators or shutters etc.

MOP BRUSH (17)

The MOP brush is ideal for cleaning all washable surfaces; thanks to its special cardan joint, it easily reaches even those less accessible floor areas.

How to apply the microfibre cloth frame: position the Mop brush on the microfibre cloth frame, making the three fixed hooks on the frame match with the three seats on the edge of the brush. Push downwards until the frame is hooked to the brush through the three lever hooks.

Place the microfibre cloth on the frame making the velcro correspond.

To unhook the microfibre cloth frame, hold the brush by the joint and pull it upwards, unhooking two lever hooks at the same time and then the third one until the brush is separated from the frame.

To clean floors, use the special microfibre cloth frame with velcro swinging back and forth without applying any pressure.

Use the brush without frame on particularly dirty or encrusted areas and in spaces between the tiles: swing the brush sideways to detach the dirt. For highly obstinate stains and corners, the Mop brush can be directly connected to the steam gun for more cleaning power.

Mondialvap is ideal for both synthetic and wool rugs as well as for all types of carpets.

Its use will ensure total hygiene, revive colours and restore the original brilliance of the pile.

The treatment can be repeated as frequently as you wish, with no damage whatsoever.

Drying occurs practically at once.

TRIANGULAR BRUSH (20)

The accessory whose shape allows access into the most difficult corners.

CARE OF YOUR MONDIALVAP 3000

Before attempting any maintenance operation, be sure to always disconnect the appliance from the mains.

We recommend that the bristles of the brushes are allowed to cool down in their normal position after use, so as to avoid any mis-shaping.

Check periodically the condition of the rubber washer connections on the extension tubes **(2)** and on the steam gun **(R)**. If necessary, replace the washers with the exchange washers **(8)** supplied with your Mondialvap 3000.

To clean the body of the appliance, simply use a moist cloth. Do not use solvents or detergents which may harm the body material.

Position an empty container under the machine, take the hose **(Q)** out from its storage **(P)**. Lift upwards the spring muff which covers the boiler cock **(W)** and with an hexagonal tube spanner of size 10 turn the opening device anti-clockwise. Insert the plug and push the mains supply switch **(A)**. This activates the pump and starts the washing process. When washing is completed, unplug the appliance and screw the device clockwise back in its place.

Switch the appliance on pushing only the main supply switch **(A)**, enabling the generator to refill again and only when it is full, activate the starter switch **(B)**.

Attention! if the generator is not full enough of water, the heating elements may burn out.