

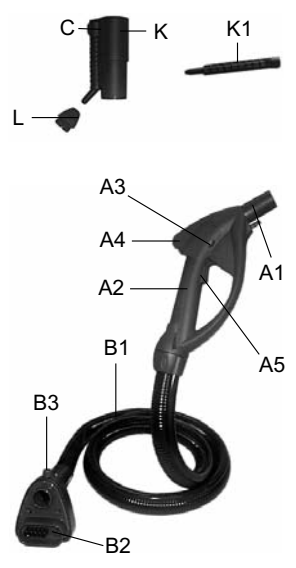

mondial vap

SPECIAL CLEANER

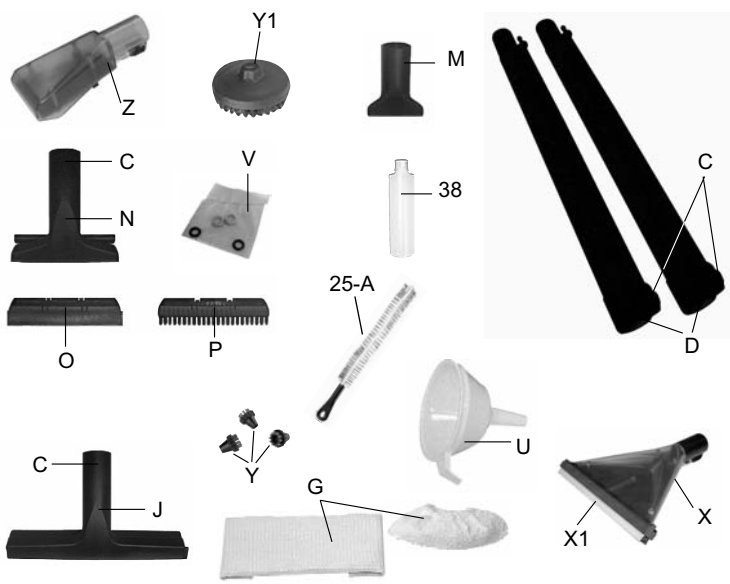

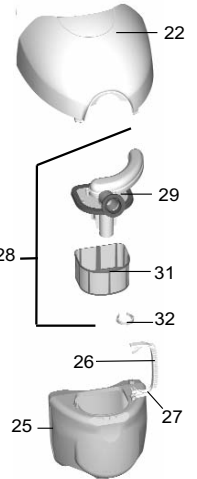
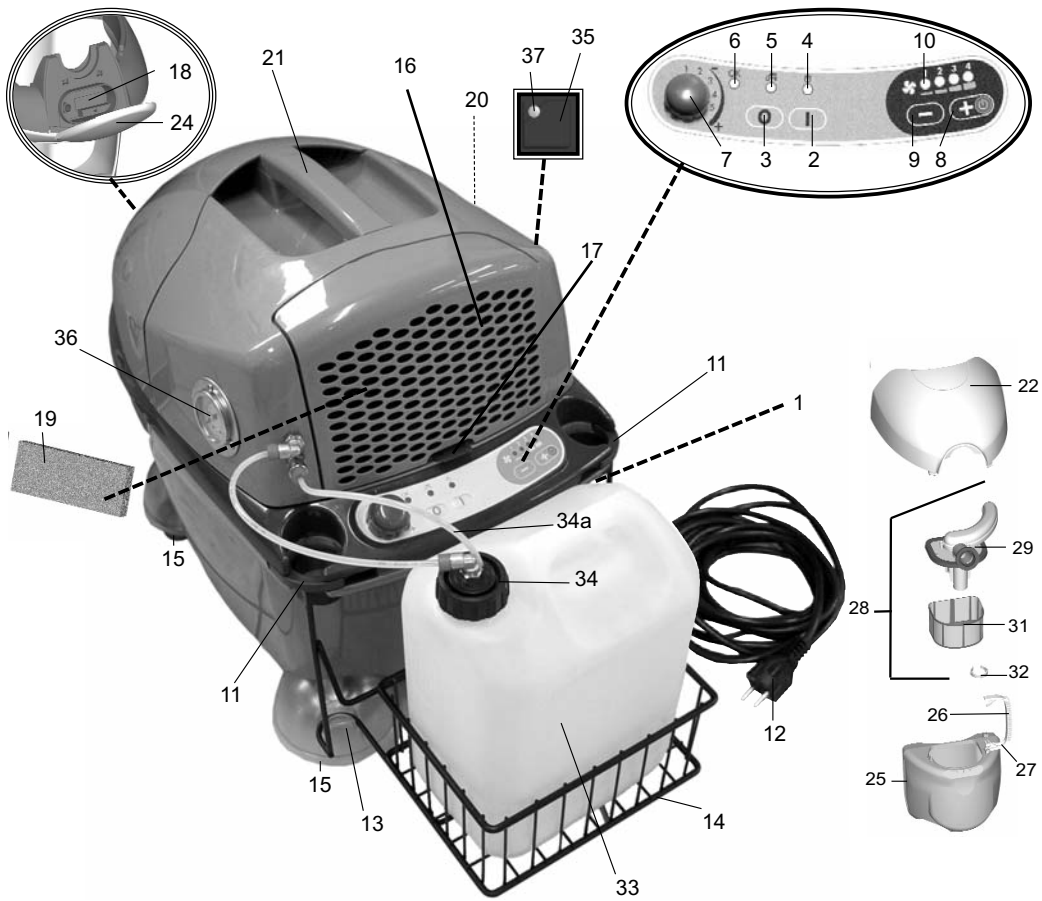

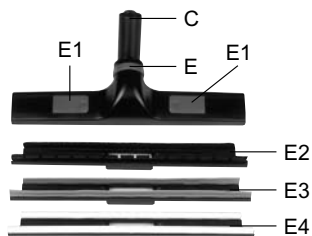
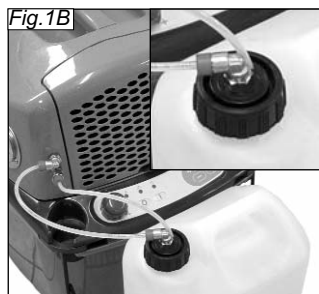
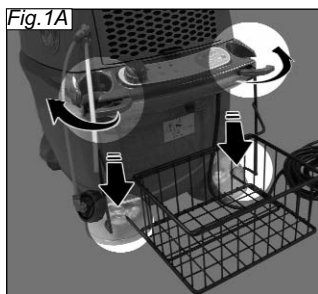
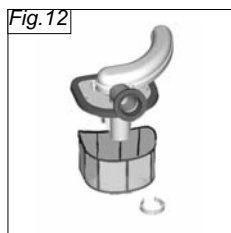
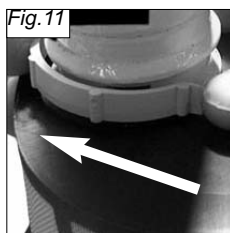
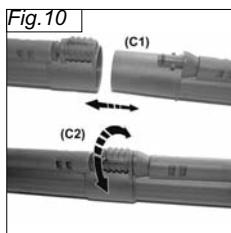
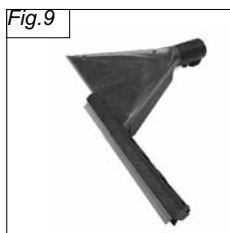
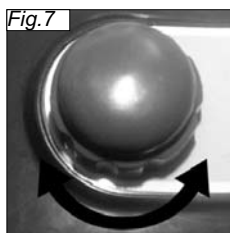
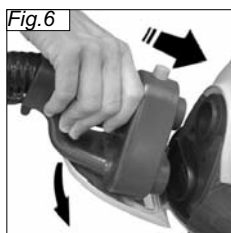
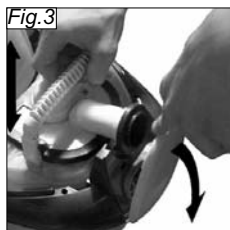
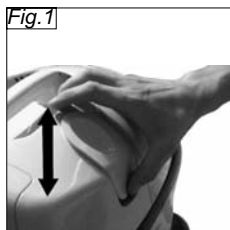

MONDIAL VAP SPECIAL CLEANER



Read these instructions carefully before using the appliance.

KEY

- 1) Main switch
- 2) Boiler on button
- 3) Boiler off button
- 4) Boiler ON indicator light
- 5) Low water level indicator light
- 6) Pressure indicator
- 7) Steam adjustment knob
- 8) Vacuum ON/higher vacuum power button
- 9) Lower vacuum power button
- 10) Higher vacuum power indicator lights
- 11) Cable winder pins
- 12) Power cable
- 13) Detergent rack support seats
- 14) Detergent rack
- 15) Swivelling wheels
- 16) Air outlet grid
- 17) Air outlet grid opening lever
- 18) Unit socket
- 19) Rear sponge filter
- 20) Automatic refilling tank cap
- 21) Carry handle
- 22) Lid
- 24) Unit socket door
- 25) Water container
- 26) Water container handle
- 27) Water container handle opening lever
- 28) Water filter assembly
- 29) Filter cage cover
- 31) Filter body with mesh screen
- 32) Filter body locking ring
- 33) Detergent tank
- 34) Detergent tank cap with dip tube
- 34a) Auto priming tube
- 35) Detergent switch
- 36) Pressure gauge
- 37) Detergent function indicator light
- 38) Antifoam

KEY TO ACCESSORIES

- A1) Accessory connection
- A2) Handle
- A3) Safety button
- A4) Vacuum button
- A5) Steam button
- B1) Steam+vacuum hose
- B2) Unit plug
- B3) Unit plug locking button
- C) Accessory locking button
- D) Steam+vacuum extension tubes
- E) Multipurpose brush
- E1) Attachments locking slides
- E2) Brush attachment
- E3) Vacuum liquid attachment
- E4) Carpet attachment
- G) Cotton cloths
- J) Vacuum-steam squeegee attachment
- K) 120° vacuum-steam accessory
- K1) Steam lance
- L) Small coloured 120° vacuum-steam brushes
- M) 120° vacuum-steam nozzle
- N) Small vacuum-steam nozzle
- O) Squeegee attachment for small vacuum-steam nozzle
- P) Brush attachment for small vacuum-steam nozzle
- U) Funnel
- V) Spare gaskets
- Z) Fabrics brush with sprayer
- X) Floors brush with sprayer
- X1) Floor brush attachment with sprayer

OPTIONAL ACCESSORIES

- Y) Brass bristle brushes
- Y1) Round Ø80 brush for 120° accessory

PRECAUTIONS

KEEP THESE INSTRUCTIONS

- Read these instructions for use carefully before using the appliance.
- Any use which does not comply with these instructions will invalidate the warranty.
- The wiring system to which the appliance is connected must always comply with the laws in force.
- Before connecting the appliance, make sure that the mains voltage is the same as the voltage indicated on the data label of the appliance and that the power outlet is connected to earth
- Always turn off the appliance at the on/off switch before unplugging it.
- If the appliance is left unused, always disconnect it from the mains. Never leave the appliance unattended with the cable plugged into the mains.
- Always make sure the appliance is unplugged before performing any maintenance work.
- Do not pull the power cable out of the socket, but grasp the plug itself to avoid damage to the socket.
- Do not allow the power cable to be twisted, crushed, stretched, or come into contact with sharp or hot surfaces.
- Do not use the appliance if the power cable or other important parts are damaged.
- Do not use electric extension leads that are not authorized by the manufacturer, as they may cause damage or fire.
- If it is necessary to replace the power supply cable, please refer to the nearest Polti authorised service centre, since the use of a special tool is necessary.
- Never touch the appliance with wet hands or feet with the cable plugged into the mains.
- Do not use the appliance when barefoot.
- Do not use the appliance near a bathtub, shower or container full of water
- Never immerse the appliance, the cable or the plugs in water or another liquid.
- Use of the appliance in places where there is a danger of explosions is prohibited.
- Do not use the product with toxic substances.
- Do not lay the hot appliance on surfaces sensitive to heat.
- Do not leave the appliance exposed to wind or rain.
- Do not place the appliance near a live element, an electric stove or any other source of heat.
- Do not expose the appliance to extreme temperatures
- Never let children or people who are not familiar with how the appliance works use it.
- Do not press the buttons hard or with a pointed object such as a pen.
- Always rest the appliance on a stable surface.
- In case of accidental fall of the appliance it is necessary to have it checked by an authorized Service Centre as the internal safety features may have been affected.
- In case of breakdown or malfunction switch off the appliance and never attempt to disassemble it, but refer to an authorized Service Centre.
- In order to avoid prejudicing the safety of the appliance, use only original spare parts and accessories approved by the manufacturer.
- Do not wind the power cable around the appliance, especially when the appliance is still hot.
- Do not use the appliance to suck up acids or solvents, as these might cause serious damage to the appliance and above all do not suck up explosive dust or liquids, as these could cause explosions on coming



This unit conforms with EC-directives 89/336 as amended by 93/68 (EMC) and 73/23 as amended by 93/68 (low voltage).

Polti S.p.A. reserves the right to change equipment or accessory specification without prior notice.

MONDIAL VAP SPECIAL CLEANER

into contact with the inside components of the appliance.

- Do not suck up toxic substances.
- Do not suck up burning or incandescent objects such as embers, ash or other material in which combustion is taking place.
- Water tank can be filled with tap water.
- Do not suck up materials such as cement, chalk etc. which solidify once they come in contact with water thus damaging the appliance
- During refilling with water, switch off and disconnect the appliance from the mains.
- It is necessary to keep the unit in horizontal position during operation.
- Do not direct the steam jet on electrical or electronic appliances.
- Make sure the appliance has cooled down before cleaning it.
- Before storing the appliance make sure that it has completely cooled down.
- This appliance is equipped with safety devices which are to be replaced only by a suitably qualified technician.
- Do not direct the steam jet at people, animals or debris.
- Never place your hands inside the jet of steam.



ATTENTION:
Danger of burns!

- Do not put any detergent or chemical substance in the boiler.
- This appliance is not intended for use by persons (including children) with reduced physical, sensory or mental capabilities, or lack of experience and knowledge, unless they have been given supervision or instruction concerning use of the appliance by a person responsible for their safety.
- Children should be supervised to ensure that they do not play with the appliance.
- Never leave the appliance unattended when turned on.

ATTENTION

Directive 2002/96/EC (Waste Electrical and Electronic Equipment - WEEE):
information for users

This product complies with EU Directive 2002/96/EC.



The crossed-out wastebasket symbol on the appliance means that at the end of its useful lifespan, the product must be disposed of separately from ordinary household wastes.

The user is responsible for delivering the appliance to an appropriate collection facility at the end of its useful lifespan.

Appropriate separate collection to permit recycling, treatment and environmentally compatible disposal helps to prevent negative impact on the environment and human health and promotes recycling of the materials making up the product. For more information on available collection facilities, contact your local waste collection service.

CORRECT USE OF THE PRODUCT

This appliance is intended for professional use as a steam generator and liquid/damp vacuum cleaner in accordance with the descriptions and instructions provided in this manual. Please read these instructions carefully and keep them for future reference.

Polti declines liability for any damage or accident derived from any use of Mondial Vap which is not in conformity with the instructions contained in this booklet.

PREPARATION FOR USE

- Pull up the cap on the automatic refilling tank (20) (Fig.1) and fill the tank with ordinary water using the funnel (U), up to the MAX level indicated on the filling opening (about 2.6 l).

If your water is particularly hard, use a mixture of 50% tap water and 50% demineralised water.

- Put the cap (20) back in its place, ensuring that it is screwed on properly.

MONDIAL VAP SPECIAL CLEANER

- Pull the lid upwards (22) as shown in fig. 2 to release it.
- Lift the water container (25) pulling it out of its housing by the container handle (26), moving the unit socket door (24) aside as shown in fig. 3.
- Press the water container handle (27) opening lever and pull (fig. 4).
- Remove the water filter assembly (28) (fig. 5) and fill the container (25) with about 0.5 l ordinary tap water.
- Add one dose (a full cap) of antifoam (38) to the water.
- Put the filter assembly (28) back in the water container (25) in its initial position. Close the container handle (26), ensuring it is closed properly.
- Put the water container back, proceeding in opposite order to the above and making sure that the air hose present on the water filter assembly is aligned with the connection on the appliance.
- Put the lid back (22), aligning the two levers on the lid with the two seats on the appliance, turning the lid to connect it.

PREPARING THE DETERGENT

- Open the cable winder pins (11).
- Insert the detergent rack (14) in its housing (13) (fig.1A).
- Fill the tank (33) with some properly diluted detergent and place it in the rack (14).
- Insert the detergent tank cap with dip tube (34), screwing it in carefully (fig.1B).
- Insert the auto priming tube (34a) inside the hole on the cap (34) (fig.1B).

CLEANING PRODUCTS:

We recommend use of cleaning products from the Polti HP007 PROFESSIONAL line only, as they are specifically designed and tested for use with Mondial Vap steam appliances.

Refer to product labels for information on dilution percentages and how to use Polti HP007 PROFESSIONAL products.

CAUTION:

- Never use foamy or acidic cleaning products,

as they could damage the components inside the appliance.

- Never use cleaning products containing muriatic acid, ammonia or products classified as irritant, as use of irritating products with steam increases their volatility so that they can be hazardous to the health if inhaled.
- **Problems caused by use of cleaning products other than those recommended above will not be covered by the guarantee.**

OPERATION

- Open the unit socket door (24); plug in the unit plug (B2) all the way, without pressing the button, until you hear the mechanism click together, then check that it is connected properly (fig. 6).
- To disconnect the unit plug (B2) from the appliance, press the button (B3) and pull the unit plug away from the appliance.
- Plug into a suitable electrical outlet.

Operation with Steam + Suction

- Press the main switch (1) below the control panel. The first level on the vacuum indicators (10) will start to flash.
- Press the boiler on button (2). The boiler ON indicator light will go on (4).
- Wait until the pressure indicator (6) goes on.

NOTE: the detergent switch (35) must be turned off, so that the indicator light (37) is green. Mondial Vap is now ready to produce steam.

- Press the steam button (A5) on the handle to dispense steam. You can start vacuuming at the same time by pressing the vacuum button (A4).
- You can start vacuuming either by pressing the ON button (8) on the control panel or by pressing the vacuum button (A4) on the handle (A2) for two seconds.

Note: The handle (A2) has a safety button (A3) which prevents accidental dispensing of steam by children or people unfamiliar with operation of the appliance. If you need to leave the appliance temporarily unattended while it is on, lock the safety

MONDIAL VAP SPECIAL CLEANER

button (A3). Unlock to start dispensing steam again.

Operation with suction only

Read the section on “suction power adjustment / switching OFF” for information on proper use for vacuum cleaning.

- If you wish to operate the appliance using the vacuum feature only, press the main switch (1) below the control panel, and the first level on the vacuum indicators (10) will start flashing.
- You can start vacuuming either by pressing the ON button (8) on the control panel or by pressing the vacuum button (A4) on the handle (A2) for two seconds.
- Using the control panel: press the ON button (8) for a few seconds, and the vacuum will start to work at maximum speed, while the first level on the vacuum indicators (10) will stop flashing and stay on.
- Using the handle: press the button (A4) on the handle (A2), and the vacuum will start to work at maximum speed, while the first level on the vacuum indicators (10) will stop flashing and stay on.

IMPORTANT CAUTION: Vacuum cleaning should be used to pick up liquids/wet substances only, NOT for collecting dry dirt.

Operation with steam only

- Press the main switch (1) below the control panel, and the first level on the vacuum indicators (10) will start flashing.
- Press the boiler on button (2). The boiler indicator light will go on (4).
- Wait until the pressure indicator light (6) goes on.
NOTE: the detergent switch (35) must be off, so that the indicator (37) is green. Mondial Vap is now ready to produce steam.
- Press the steam button (A5) on the handle to dispense steam.
- If you do not wish to use steam any longer, turn off the boiler by pressing the boiler off button (3).

Detergent feature

- Press the main switch (1) below the control panel, and the first level on the vacuum indicators (10) will start flashing.
- Press the boiler on button (2). The boiler indicator light will go on (4).
- Press the detergent switch (35). The function indicator (37) will turn orange. Now press the steam button (A5), and a jet of detergent mixed with steam will appear.
- To turn off the detergent function, press the switch (35) again. The indicator (37) will turn green.

FILLING THE BOILER

The automatic filling system means you no longer have to stop and wait before you can fill the boiler with water again. When the water level in the boiler is low, the level probe automatically requests water from the tank, working a pump and filling the boiler. If there is no water in the automatic filling tank, the indicator light (5) will go on and an acoustic signal will sound. The appliance will stop producing steam. To continue working, fill the tank as described in the section on "Preparation for use".

STEAM FLOW ADJUSTMENT

Mondial Vap enables you to optimise the steam flow by means of the adjustment knob (7) (Fig. 7).

To obtain a higher flow rate turn the knob in a clockwise direction. When the knob is turned in an anti-clockwise direction, the flow rate decreases.

High flow rate of steam:

to remove caked dirt, stains, grease and to sanitise;

Normal flow rate of steam:

for wall-to-wall and loose carpeting, windows, floors;

Low flow rate of steam:

for spraying plants, cleaning delicate fabrics, wallpaper, etc.

DO NOT USE STEAM ON DRAYLON, VELVET OR OTHER SENSITIVE SURFACES.

NOTE: if the detergent function is on, you

MONDIAL VAP SPECIAL CLEANER

can use the adjustment knob (7) to adjust the amount of steam mixed with the detergent.

SUCTION POWER ADJUSTMENT / SWITCHING OFF

You can control the suction power depending on the kind of surface to be treated. The numbers are those indicated on the control panel.

- 1 for curtains
- 2 for sofas and cushions
- 3 for carpets
- 4 for hard floors and for collecting liquids

Use of the suction controls on the control panel

Press the vacuum on/higher vacuum power button (8) and the lower vacuum power (9) to adjust the vacuum power. Each time you press the higher vacuum power button (8), vacuum power will be increased, and one of the indicator lights (10) on the control panel will go on; each time you press the lower vacuum power button (9) the opposite will occur. If you hold the vacuum on/higher vacuum power button (8) down for a few seconds, vacuuming will stop.

Use of the suction controls on the handle

Simply press the vacuum on button (A4) to start vacuuming. Hold the vacuum on button (A4) to select vacuum power to suit the surface to be vacuumed. As vacuum power increases an indicator light (10) on the control panel goes on; as vacuum power decreases an indicator light (10) goes off. While the appliance is in use, it may be turned off by simply pressing the vacuum button (A4).

NOTE: When vacuuming starts, the appliance starts again at the speed in use when it was turned off.

CABLE WINDER

Before putting away the Mondial Vap, wind the power cable onto the pins (11) as follows:

- pull the cable winder pins outward (11).
- wind up the power cable (fig. 8).

ACCESSORIES CONNECTION

Mondial Vap accessories may be used together. Connect them to the steam handle as follows (fig.10):

- Put the locking button (C) (present on all accessories) in the OPEN position (C1).
- Attach the desired accessory to the handle.
- Put the locking button (C) in the CLOSED position (C2).
- Check that the connection is tight.

VACUUMING

When the water in the filter is very dirty, replace it as described in the section on “Emptying and cleaning the water container”. When dirt in the water container (25) reaches the maximum permitted level, vacuuming will be automatically shut down by the safety float (you will hear the motor running faster).

CAUTION: turn off the appliance and do not start it up again until you have put water in the container as described in the section on “Emptying and cleaning the water container”. If you attempt to turn on the appliance before this, you could damage the air outlet filter.

To resume cleaning, proceed as described in the section on “Emptying and cleaning the water container”, and then add water to the container.

MONDIAL VAP SPECIAL CLEANER

EMPTYING AND CLEANING THE WATER CONTAINER

- Turn off the appliance by pressing the main switch (1) and unplug it.
- Pull the lid (22) upwards as shown in fig. 2 to release it.
- Lift the water container (25) out of its housing by its handle (26), moving the unit socket door (24) aside as shown in fig.3.
- Press the water container handle opening lever (27) and pull (fig. 4). Remove the water filter unit (28) (fig. 5), empty the container and rinse it out. Release the filter body locking ring (32) by pulling it outwards (fig.11).
- Separate all components and rinse them in running water (fig.12).
- If you wish to continue cleaning, refill the container with water.
- A cleaning brush (25-A) is provided for cleaning the water container (25), which may also be used to clean the connections on the appliance's hoses and the inside of accessories.
- Put the water filter assembly (28) back in the container, close the handle on the container (26), ensuring that it is positioned correctly and put the whole back into the appliance.
- Replace the lid (22), make sure that the two lever on the lid are aligned with the two seats on the appliance and turn it until the lid is anchored on (22).

Note: empty the water container (25) before storing the Mondial Vap. One of the biggest advantages of the Mondial Vap is that it can be put away clean.

PRESSURE INDICATOR

Mondial Vap is equipped with a precise indicator instrument (36) displaying operating pressure.

TIP FOR USING THE ACCESSORIES

Before treating leather, special fabrics (especially dralon and velvet) or wooden surfaces with steam, consult the manufacturer's instructions and always proceed only after carrying out a test on a hidden part or a sample. Allow the area treated with steam to dry and then check whether any changes in colour or deformations have occurred before proceeding further, ensuring exactly the same steam power and distance as in the test.

When cleaning wooden surfaces (furniture, doors, etc.) and brick floors always proceed with caution since excessive use of steam could damage the wax, the polish or the colour of the surface to be cleaned. It is therefore advisable to apply the steam to these surfaces only for short periods at a time or to clean them with a cloth that has been treated with steam.

On particularly delicate surfaces (e.g. synthetic materials, enamelled surfaces, etc.) we strongly recommend to use the steam at its lowest output power. When cleaning glazed surfaces, if the weather is particularly cold pre-heat the glass working at distance of about 50 cm away from the surface. To take care of your plants, we recommend spraying them from a distance of at least 50 cm.

MULTIPURPOSE BRUSH (E)

Use of this brush is recommended for large surfaces such as ceramic or marble flooring, wooden flooring, carpets, etc..

- Brush attachment (E2), when the suction function alone is required.
- Liquid-suction fitting (E3), for removing moisture, suitable for smooth surfaces.
- Carpet fitting (E4), suitable for wall-to-wall carpeting and loose carpets.

The multipurpose brush can be connected to the hose by means of the extension tubes (D) or it can be fitted directly onto the handle.

Assembly of the multipurpose brush:

To apply the different fittings to the multipurpose brush, move the two slides (**E1**) on the rear of the brush outwards and apply the appropriate fitting for the type of surface to be cleaned. To lock the fitting into place move the two slides (**E1**) inwards.

Do not apply steam directly to wooden surfaces.

VACUUM-STEAM SQUEEGEE ATTACHMENT (J)

Use of this accessory is recommended on large windows, large mirrors and smooth surfaces in general. The vacuum-steam squeegee attachment (**J**) can be connected to the steam-vacuum hose by means of the extension tubes (**D**) or it can be fitted directly onto the handle (**A2**). To use the vacuum-steam squeegee attachment correctly, proceed as follows:

- Release steam evenly onto the surface to be cleaned in order to dissolve the dirt.
- Press the rubber wiper onto the surface to be cleaned, moving it from the top downwards with the suction function on.

Warning: When the weather is particularly cold, pre-heat the windows by releasing steam from a distance of about 50 cm onto the surface to be treated.

120° VACUUM-STEAM ACCESSORY (K)

We suggest to use this accessory to clean areas that are difficult to reach with other accessories. The 120° accessory can be used for:

- treating stains on carpeting or loose carpets, before going over them with the brush;
- cleaning stainless steel, windows, mirrors, layered coating and paintwork;
- cleaning corners such as stairs, window casings, door jambs, aluminium sections;
- cleaning the bases of taps;
- cleaning blinds, radiators, the interiors of cars;
- atomising house plants from a distance.

- eliminating odours and creases from clothing.

The 120° accessory can be fitted directly onto the handle (**A2**) or it can be connected to the steam-suction hose by means of the extension tubes (**D**).

It is possible to combine the 120° accessory with the following accessories:

- **small coloured 120° brushes (L)**, suitable for removing caked dirt from very small surfaces such as cooking rings, shutters, between tiles, sanitary fittings and so on.
The different colours allow you to always use the same small brush on the same type of surface.
- **The steam lance (K1)** allows you to reach the most inaccessible places. Ideal for cleaning radiators, door jambs, sills, shutters and toilet bowls. To connect the lance to the 120° accessory screw it on the 120° accessory, as you screw the coloured brushes. The coloured brushes can be screwed on the lance itself.
- **120° vacuum-steam nozzle (M)**, recommended for removing dirt from narrow surfaces such as the spaces between tiles, door jambs, shutters, etc.

SMALL VACUUM-STEAM NOZZLE (N)

Use of this accessory is recommended on various type of medium-sized surfaces or for cleaning textile surfaces such as sofas, mattresses and so on, using the following fittings supplied with it:

- the window-cleaning attachment (**O**) is recommended for small mirrors, small windows, reinforced concrete and glass walls, etc..
- the brush attachment (**P**) is recommended for carpets, stairs, the interiors of cars, textile surfaces in general, and for removing animal hairs from these surfaces.

MONDIAL VAP SPECIAL CLEANER

FABRICS BRUSH WITH SPRAYER (Z)

This accessory is recommended for treating fabrics on sofas, armchairs, etc. with the combined action of water mist and suction.

FLOORS BRUSH WITH SPRAYER (X)

NOTE: use this accessory with detergent function only, not steam function. This brush is recommended for large surfaces and floors made of ceramic tiles, marble, parquet, carpets, etc., combining the action of water mist and suction. You can separate the attachment (X1) from the brush by sliding it off as shown in figure 9, to glide more easily over carpets and rugs.

GENERAL MAINTENANCE

- Before carrying out any type of maintenance make sure that the power cable has been disconnected from the mains.
- After using the brushes it is advisable to let them cool in their natural position so as to avoid deformation.
- Check the conditions of the gaskets located inside the unit plug (B2) periodically. If necessary, replace them with the appropriate spares. Also carry out the same check on the gaskets for connecting the extension tubes (D) and the handle (A2).

To clean the outside of the appliance, just use a damp cloth. Do not use solvents or detergents as these might damage the plastic surface.

Cleaning or replacing the rear sponge filters (19).

Unhook the opening lever of the air outlet filter grid (17) and turn it upwards (fig.13). Remove the sponge filters (19) and clean them periodically by washing them in running water. Replace them with original Polti spare parts when deteriorated.

Let the filters cool down before putting them back into the appliance

OPTIONAL ACCESSORIES

Brushes with brass bristles (Y)

The brushes with brass bristles are used with the 120° steam-suction accessory (K). BRASS BRISTLES ARE TO BE APPLIED TO HARD, DURABLE, NON-SCRATCH SURFACES ONLY. TEST IN A NON-VISIBLE SPOT BEFORE PROCEEDING.

This accessory is suitable for cleaning particularly resistant surfaces such as hard floors, garden furniture, machine tools, etc..

Round Ø80 brush for 120° accessory (Y1)

The round Ø80 brush is used with the 120° accessory (K). It is useful for removing grease or deposits. It combines steam with the abrasive action of nylon bristles.

MONDIAL VAP SPECIAL CLEANER

TROUBLESHOOTING

TROUBLE	CAUSE	SOLUTION
The suction fan does not start	No power supply	Check cable, plug and socket
The boiler filling pump can be heard working continuously	Air in the boiler circuit.	Switch the appliance off, let it cool and repeat the operations described in the "OPERATION" chapter.
The suction power drops	The small suction accessory, the steam-suction hose or the tube are clogged.	Clean the filter and remove any obstruction from the tubes and accessories.
Water is spilled while sucking up liquids.	Float device clogged	Clean the water filter assembly.
Suction has stopped	Float device has interrupted suction	Switch the appliance off, make sure that water level in the container is correct and switch the appliance on.