



ceeding to clean further areas, ensuring that exactly the same distance and technique are applied as for the test area. If in doubt, and on sensitive surfaces like fabrics, leather and wood it is always better to ask advice from your Steam Cleaner dealer.

14. Do not use VAPORETTO on only delicate fabrics.

15. If cleaning glass surfaces in particularly low temperatures preheat the glass using the hand gun from about 50 centimetres distance from the surface to be cleaned.

16. It is necessary to keep the unit in horizontal position during operation.

**SPECIAL INSTRUCTIONS**

1. To avoid a circuit overload, do not operate another high wattage appliance on the same circuit.
2. If an extension cord is absolutely necessary, a 15 ampere cord should be used. Cords rated for less amperage may overheat. Care should be taken to arrange the cord so that it cannot be pulled or tripped over.

**SAVE THESE INSTRUCTIONS**

**PRECAUTIONS**

- KEEP THESE INSTRUCTIONS**
- Read these instructions for use carefully before using the appliance, and make sure that anyone using the machine is familiar with these instructions and the warnings.
  - **DO NOT USE THE STEAM FUNCTION ON DRAYLON, VELVET, LEATHER OR OTHER SENSITIVE FABRICS.**
  - Any use which does not comply with these instructions will invalidate the warranty.
  - The wiring system to which the appliance is connected must always comply with the laws in force.
  - Before connecting the appliance, make sure that the mains voltage is the same as the voltage indicated on the data label of the appliance and that the power outlet is connected to earth
  - Always turn off the appliance at the on/off switch before unplugging it.
  - If the appliance is left unused, always disconnect it from the mains. Never leave the appliance unattended with the cable plugged into the mains.
  - Always make sure the appliance is unplugged before performing maintenance work of any kind
  - Do not pull the power cable out of the socket, but grasp the plug itself to avoid damage to the socket.
  - Do not allow the power cable to be twisted, crushed, stretched, or come into contact with sharp or hot surfaces.
  - Do not use the appliance if the power cable or other important parts are damaged.
  - Do not use electric extension leads that are not authorized by the manufacturer, as they may cause damage or fire.
  - If it is necessary to replace the power supply cable, please refer to the nearest Polti authorised service centre, since the use of a special tool is necessary.
  - Never touch the appliance with wet hands or feet with the cable plugged into the mains.
  - Do not use the appliance when barefoot.
  - Do not use the appliance near a bathtub, shower or container full of water
  - Never immerse the appliance, the cable or the plugs in water or another liquid.
  - Use of the appliance in places where there is a danger of explosions is prohibited.
  - Do not use the product with toxic substances.
  - Do not lay the hot appliance on surfaces sensitive to heat.
  - Do not leave the appliance exposed to wind or rain.
  - Do not place the appliance near a live element, an electric stove or any other source of heat.
  - Do not expose the appliance to extreme temperatures
  - Never let children or people who are not familiar with how the appliance works use it.
  - Do not press the buttons hard or with a pointed object such as a pen.
  - Always rest the appliance on a stable surface.
  - In case of accidental fall of the appliance it is necessary to have it checked by an authorized Polti Service Centre as the internal safety features may have been affected.
  - In case of breakdown or malfunction switch off the appliance and never attempt to disassemble it, but refer to an authorized Service Centre.
  - To avoid prejudicing the safety of the appliance, use only original spare parts and accessories approved by the manufacturer.
  - Do not wind the power cable around the appliance, especially when the appliance is still hot.
  - During refilling with water, switch off and disconnect the appliance from the mains.
  - It is necessary to keep the unit in horizontal position during operation.
  - Do not direct the steam jet onto electrical and/or electronic appliances.
  - Let the appliance cool down before cleaning it.
  - Before storing the appliance make sure that it has completely cooled down.
  - This appliance is equipped with safety devices which are to be replaced only by a suitably qualified technician.
  - Do not direct the steam jet at people, animals or debris.
  - Never place your hands inside the jet of steam.

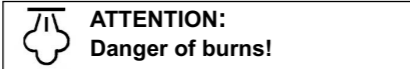

- When Refilling the boiler, use **HOT** rather than cold water, pour in gently at first and keep exposed skin and your face away. Otherwise the still hot tank walls can spit drops of very hot water or steam spray.
- Do not put any detergent or chemical substance in the boiler.
- **We recommend you use original Polti products only, as products of other brands may not be**

**suitable for use in Polti products and could cause damage.**

- **Never use distilled water or scented water.**
- Make sure the patented safety cap is fully and correctly screwed on, otherwise you may experience steam escaping from around the cap.
- Check periodically the safety cap and **MAKE SURE** the rubber gasket is in place around the base of the screw thread.
- Replace with original spare parts if necessary. **DO NOT USE** the appliance if the rubber gasket is not in position.
- Do not refill the tank while it is still hot, allow it to cool down for a few minutes before refilling.
- Do not empty the appliance when the water in the boiler is still hot.
- Do not try to unscrew the safety cap when the appliance is in use.
- This appliance is not intended for use by persons (including children) with reduced physical, sensory or mental capabilities, or lack of experience and knowledge, unless they have been given supervision or instruction concerning use of the appliance by a person responsible for their safety.
- Children should be supervised to ensure that they do not play with the appliance.

**CORRECT USE OF THE PRODUCT**

This appliance is intended for home use as a steam generator as described and in accordance with the instructions provided in this manual. Please read these instructions carefully and keep them, as you may find them useful in future.

**ATTENTION**

- This appliance is built according to current regulations for recycling.
- Do not throw the appliance and packing materials used to protect the appliance during transportation, but take them to relevant collecting centers.
- Polti declines liability for any damage or accident derived from any use of VAPORETTO which is not in conformity with the instructions contained in this booklet.

**IMPORTANT**

Before leaving our factory all our products are rigorously tested. For this reason, your Vaporetto may contain some residual water in the boiler.

**INSTALLATION**

Before using Vaporetto for the first time assemble the rotating wheels as indicated in the Fig. A.

**PREPARATION FOR USE**

1. Unscrew the patented safety cap (A) and fill the boiler with about 2 litre of water using the filler bottle (14) making sure that it does not overflow (fig. 1)
- It is possible to use simple tap water. Nevertheless, since water by its nature contains lime scale which could cause hard deposits, we recommend to use a mixture of 50% of tap water and 50% of demineralized water.
2. Carefully screw on the safety cap to hand tight (Fig. 2). Make sure the patented safety cap (A) is fully and correctly screwed on, otherwise you may experience steam escaping from around the cap.
3. Connect the power supply cable (F) into an earthed power supply of the correct voltage.

**WARNING:** Do NOT under any circumstances put or leave the filler bottle in the water filling aperture of the appliance when the appliance is connected to the mains electricity supply. Danger of burns!

**INSTRUCTIONS FOR USE**

- 1a. Press down the generator on/off switch (B) and the accessories on/off switch (C) which will light up together with the pressure indicator light (K).
- 2a. Insert the connector assembly (4) pressing the connector button (5) and make sure that the locking tab (6) is correctly positioned in the lock-in aperture (E) on the block (Fig. 3).
- 3a. Wait for the pressure warning light (K) to go out. VAPORETTO is now ready for use.
- 4a. The steam gun (2) is equipped with a safety switch (2A) which prevents the accidental start of the steam jet by children or people who do not know how to operate the appliance. With the switch (2A) in the "OFF" position, the lever controlling the steam jet is locked (Fig.4b). Should the hose be left unattended for a moment whilst the appliance is connected to the mains, it is recommended to put the safety switch in the "OFF" position. To start working, set the (2A) switch to the "ON" position and press the steam button (Fig.4a). The first burst of steam may contain some water droplets, due to imperfect thermic stabilisation in the flexible hose. We would therefore advise that the first jet of steam is played onto an old cloth until a constant pressure of steam is obtained. **Note:** The pressure indicator light (K) may go on and off from time to time during use of VAPORETTO. This indicates the machine is maintaining the correct and constant pressure and is quite normal.

**STEAM REGULATION FEATURE**

Vaporetto is equipped with a steam regulation control (I) (Fig. 5). You can use this control to increase the steam flow by turning in an anti-clockwise direction. Turn the control in a clockwise direction to reduce the steam flow. Here are some suggestions for the choice of steam flow level:

Strong steam: for encrusted dirt, stains, grease and to sanitise.

Normal steam: for carpets, rugs, glass, tiles etc.

Delicate steam: to vaporise plants and clean delicate fabrics, upholstery, wallpaper etc.

Please read separate warning about use on draylon,

velvet and other delicate fabrics, or on delicate wood surfaces.

**CONNECTION OF ACCESSORIES**

All the accessories of Vaporetto can be connected to the handle or to the extension tubes as follows (fig.6):

- 1b. Move the locking button (11) of the accessory to the "open" position.
- 2b. Attach the accessory to the hand gun.
- 3b. Move the locking button (11) back to the position "closed"
- 4b. Check that the connector button has engaged and the accessory is fully connected.

**USE OF THE ACCESSORIES HOLDER**

The accessories holder allows to fix the tube with the brush mounted on it to the appliance body. Make the groove on the back of the brush slide into the guide of the accessories holder on the appliance (Fig. 7).

**PRESSURE INDICATOR**

Vaporetto is equipped with a precise indicator instrument (L) displaying operating pressure.

**PATENTED SAFETY CAP / "WATER OUT"**

The appliance is equipped with a safety cap, which prevents opening of the generator as long as there is any pressure remaining inside. This is an important and indispensable safety device, and it is necessary to follow certain procedures when re-filling the boiler. Whenever you have used up all the water proceed as follows:

- 1c. Switch off the machine at the generator on/off switch (B)
- 2c. Press the steam request lever (3) on the steam gun (2) so as to fully exhaust the steam supply from the boiler.
- 3c. Switch OFF the accessory on/off switch (C).
- 4c. Disconnect the power supply cable (F) from the mains.
- 5c. Unscrew anti-clockwise the patented safety cap (A)
- 6c. Wait for a few minutes to allow the generator boiler to cool down.
- 7c. When cool, proceed to carefully refill the boiler as described in paragraph 1 of the section "Preparation for Use". If you refill the generator when not completely cooled, we recommend you to carefully pour only very small quantities of water at each pouring into the boiler, so as to avoid squirts from the boiler, and to cover exposed skin whilst filling.

**TIPS FOR BETTER UNIT PERFORMANCE**

**WARNINGS**

- For cleaning leather, wood or delicate fabrics especially dralon, velvet and other pile surfaces, consult the manufacturers instructions. Clean only by using the hand gun at a safe distance together with a soft cloth and always do a test on a non visible part of the item first or on a sample.
- Allow the test area to dry completely before observing results and effects on surface or colour before proceeding to clean further areas.
- For cleaning wood surfaces (furniture, doors etc.) take great care as a too long application of the steam could alter the waxed appearance, the shine or the colour of the surfaces cleaned. We therefore recommend you to apply the steam on such surfaces only for brief periods or to clean these surfaces using a cloth first held in the steam.
- Please pay particular attention while cleaning brick floors: a too long application of steam could damage wax, brightness or colour of these surfaces.
- For delicate surfaces (e.g. synthetic materials, lacquered surfaces etc.) we recommend that the small brush should always be covered with at least two cloths to reduce the intensity of the steam, and (on machines with steam variation control) with the steam set at low level. Always test first on a non-visible area, allow to dry thoroughly, and if successful, make sure to use exactly the same tool, technique, steam level and steam jet distance.
- If cleaning glass surfaces in particularly low temperatures preheat the glass using the hand gun from about 50 centimetres distance from the surface to be cleaned.
- For care of your plants vaporise at a minimum distance of 50 centimetres.

**STEAM GUN (2)**

The steam gun can be used directly on all spots requiring a stronger, closer treatment without connecting the brushes. The more resistant the stain, the closer you should hold the gun, the steam pressure and temperature being higher at the source. Always wipe with a dry cloth (or a slightly abrasive sponge-if the spot is a difficult one to remove) after using the gun. Steam gun is particularly efficient at:

- breaking down rug and carpet stains before they are treated with the large brush;
- cleaning stainless steel surfaces, panes, mirrors, enamelled surfaces;
- cleaning hard-to-reach corners, such as stairs, window sills, door posts;
- cleaning cooking top knobs, taps bases
- cleaning window shutters, heaters, car interiors;
- spraying plants (from a distance);
- removing odours and creases from clothes.

To reach higher points, the steam gun can be connected to one or both extension tubes.

**LARGE BRUSH (8)**

To wash floors, put a clean, dry kitchen cloth under the brush and swing back and forth without applying any pressure. Use the other side of the cloth when the first one is impregnated with dirt. Use the brush directly without the cloth on particularly dirty or incrustated areas and in spaces between the tiles; swing the brush sideways to detach the dirt. Highly obstinate

stains may require a steam gun treatment before the brush and cloth are used (an old bath towel is an ideal cloth). Apply the same procedures to ceilings and vertical surfaces, like wallpaper. The cloth can easily be fastened around the brush and held in place by the 4 clips (9) on the brush itself. Smooth cotton cloths are suitable for the treatment of glass surfaces: fasten the cloth around the brush then pass it over the window pane (or mirror) to remove the greasy film. Finally, spray the surface with the steam gun and wipe dry with a clean cloth. In cold weather, window panes will require pre-heating with the steam gun (from a distance of 50 cm), prior to the actual cleaning with the brush. VAPORETTO is ideal for both syntetic and wool rugs as well as for all types of carpets. Its use ensures total hygiene, revives colours and restores the original brilliance of the pile. Drying occurs practically at once. Fold a cotton cloth over 2 or 3 times (according to the length and resistance of the pile) and fasten it onto the brush. Move the brush rapidly in all directions without applying any pressure. You should avoid lingering in the same place, as this may soak the area. Particularly dirty rugs may need several treatments. Obstinate stains may require the use of the steam gun (at a distance of 5-10 cm) prior to treatment.

**SMALL BRUSH (12)**

The small brush is used whenever the big brush is too big or not practical to be used. The small brush can be connected directly to the steam gun or to the extension tubes. The small brush can be used on:

- furnishing fabrics (after testing on small parts)
- velvets and leather (not too close)
- car linings, car windows
- small window surfaces
- tile and other small surfaces

To clean wood (doorposts, floors etc) do not apply the steam directly but cover the brush (big or small) with a doubled cotton cloth. For furniture cleaning, direct the steam jet onto a dry cotton cloth, and then start the cleaning. The warm moisture on the cloth traps the dust, spots and the static electricity so that the furniture stays clean longer.

**120° STEAM NOZZLE (16)**

The 120° nozzle (which can be connected directly to the gun or together with the extension tubes) allows you to concentrate a powerful jet of steam to otherwise inaccessible locations, such as radiators, door posts, sills and shutters, as well as for sterilising toilet bowls. It's a very useful and indispensable tool.

**WINDOW SQUEEGEE TOOL (18,19,20)**

The window squeegee tool allows you to clean effectively and rapidly all glass surfaces without using detergents. Your glass will remain cleaner longer thanks to the absence of the film normally left behind by chemical cleaning products on which new dust and grease can attach themselves. Cleaning glass is done in two stages:

- Spray the steam onto the surface to be cleaned to loosen the dirt (not touching with the blade).
- Pull the blade straight down the window surface from top to bottom without applying the steam, to take away the dirt.
- To clean especially large glass surfaces, attach the window squeegee tool to the extension tubes.

**LONG STEAM LANCE (21)**

This accessory allows you to reach the most inaccessible places. Ideal for cleaning large radiators or shutters etc.

**CARE OF YOUR VAPORETTO**

- Before attempting any maintenance operation, make sure to always disconnect the appliance from the mains
- We recommend that the bristles of the brushes are allowed to cool down in their normal position after use, so as to avoid any mis-shaping.
- Check periodically the condition of the coloured washer connections on the central connector (4). If necessary, replace the washers with the spare washers supplied (15). Make the same check also on the connection washers of the extension tubes (7) and of the steam gun (2).
- To clean the body of the appliance, simply use a moist cloth.

**INCREASE THE VERSATILITY OF VAPORETTO EVEN FURTHER WITH THE FOLLOWING OPTIONAL ACCESSORIES**

**TRIANGULAR BRUSH (22)**

A new accessory whose shape allows access into the most difficult corners.

**LARGE ROUND BRUSH FOR 120° STEAM NOZZLE (23)**

A very useful new accessory which allows the 120° steam nozzle to be used for cleaning larger surfaces.

**WALLPAPER STRIPPER TOOL (24)**

Specially designed for easy removal of wallpaper without significant wetting.

**GUARANTEE**

Vaporetto is guaranteed to the original purchaser for one year from purchase date against manufacturing or raw material defects. The guarantee is not valid if the appliance has been misused in any way. Unauthorised alterations or repairs to the machine will automatically invalidate this guarantee.

POLTI DECLINES LIABILITY FOR ANY DAMAGE OR ACCIDENT DERIVED FROM ANY USE OF VAPORETTO WHICH IS NOT IN CONFORMITY WITH THE INSTRUCTIONS CONTAINED IN THIS BOOKLET.

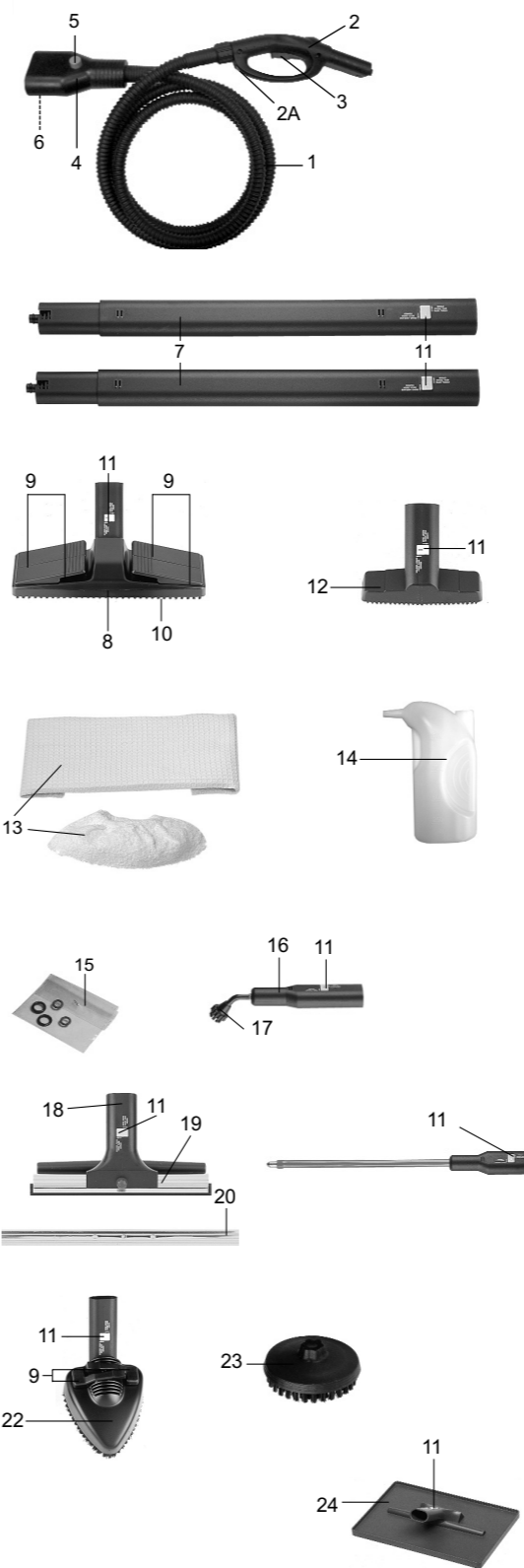
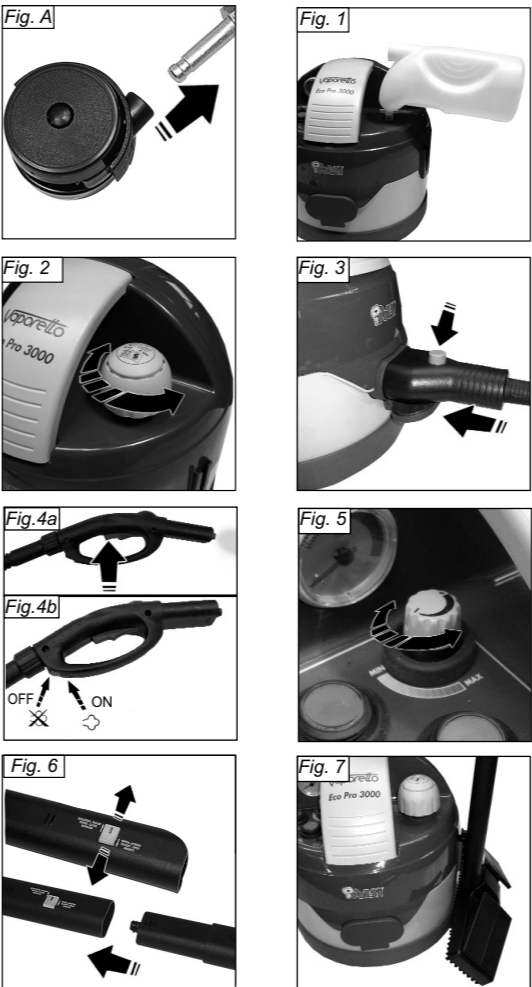
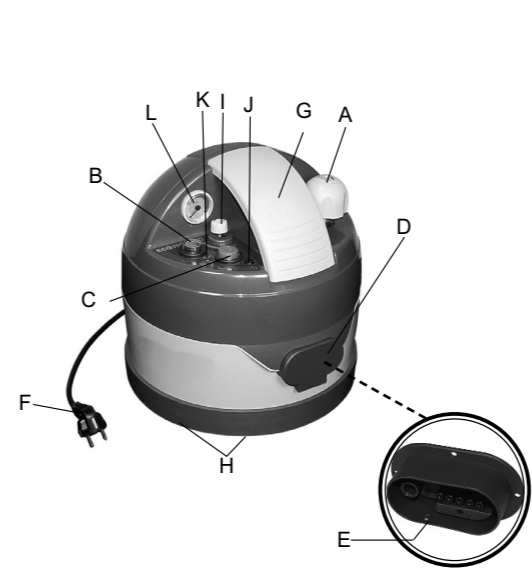

LT ECO PRO 3000 MOS0632 1F06

www.polti.com  
(CO) - Italy - Via Ferloni, 83  
Polti S.p.A. - 22070 Bulgarossa

Politi S.p.A. - 22070 Bulgarossa

**Vaporetto**  
ECO PRO 3000

CE  
Polti  
Engineering by Passion